

REV	DESCRIPTION	BY	CHK	DATE	ECN / MPS
A	RELEASE FOR SAMPLES AND ESTIMATES	AAK		04/26/07	M69954
B	ENGINEERING RELEASE	JSB		08/30/07	M70910
C	-1) 58.9±0.8/[2.32±.03] WAS 94.8 ±0.8/[3.73±.03] -2) REMOVED -A-	SMT	SSD	3/24/09	ECR15820
D	-1) 58.9±1.3 [2.32±.05] WAS 58.9±0.8 [2.32±.03] -2) WAS Ø31.75 [1.250] FLAT ROOT... -3) ADDED MAX COUPLING LENGTH	CSG	SKS	09/03/09	M76853

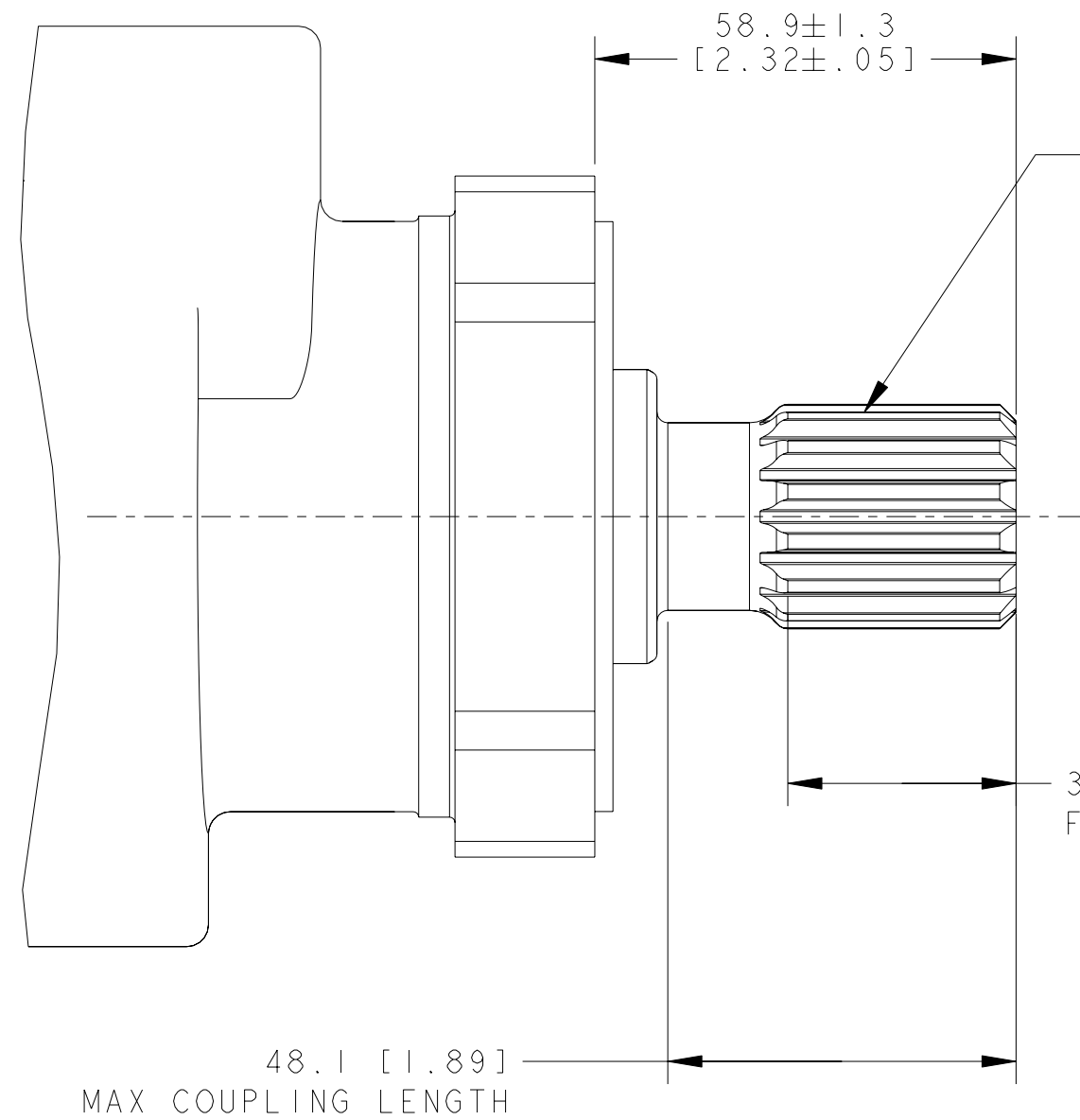

Ø31.75 [1.250] FLAT ROOT SIDE FIT
14 TOOTH 12/24 SPLINE TO FIT
PER DS-034 SEC 1

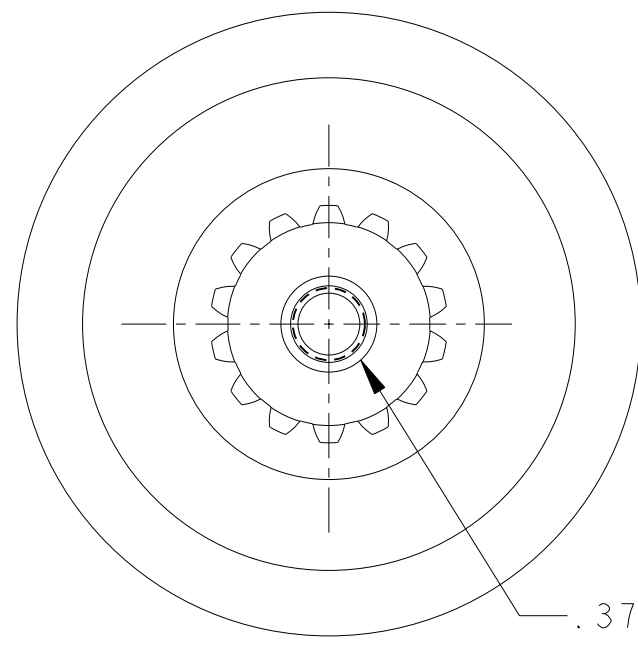

33.0 [1.30] MIN
FULL SPLINE

.375-16 UNC-2B ∇ 19.0 [1.75] MIN



REVIEWED FOR CLASSIFICATION PER ESP-042

48.1 [1.89]
MAX COUPLING LENGTH

NOTE:
1 MOUNTING TYPE : AB
2 OUTPUT SHAFT : 04

UNLESS OTHERWISE SPECIFIED ALL DIMENSIONS ARE IN INCHES <input type="checkbox"/> MILLIMETERS (INCHES) <input checked="" type="checkbox"/>	DRAWING BASED ON ANSI Y14.5M-1982	
	THE REPRODUCTION, DISTRIBUTION, AND UTILIZATION OF THIS DOCUMENT, AS WELL AS THE COMMUNICATION OF ITS CONTENTS TO OTHERS WITHOUT EXPLICIT AUTHORIZATION IS PROHIBITED. OFFENDERS WILL BE HELD LIABLE FOR THE PAYMENT OF DAMAGES. ALL RIGHTS RESERVED IN THE EVENT OF THE GRANT OF A PATENT, UTILITY MODEL, OR DESIGN. (PER ISO 16016)	
TOLERANCES .X ± 0.1 .XX ± 0.01 .XXX ± 0.001 ∠ ± 0.5°	DRAWN AAK BY/DATE 05/02/2007	MATERIAL/HEAT TREAT -
UNSPECIFIED RADII ARE: -	CHECKED NHB BY/DATE 05/02/2007	TITLE DELTA MOTOR SHAFT INSTALLATION
UNSPECIFIED DRAFT ANGLES ARE: °	ENGRG TIM BY/DATE 05/03/2007	
B SIZE	METALLURGY - BY/DATE -	NUMBER A-2977-004
	THIRD ANGLE PROJECTION DO NOT SCALE	SCALE 1/1 SHEET 1 OF 1



MICROINCHES
MICROMETERS (MICROINCHES)
ARITHMETICAL AVERAGE