

REVISIONS

REV	DESCRIPTION	DATE	APPROVED
P	REDRAWN AND REDESIGNED. 1) ADDED HVF DESIGN. 2) UPDATED DRAWING VIEW GEOMETRY TO SHOW HVF DESIGN.	2016-03-18 SBD	0120896-ECO
R	1) REMOVED PART NUMBER AND ITS CONSTRUCTION. 2) REMOVED NOTE #2 & #4. 3) TOLERANCE WAS $\pm 1^\circ$. 4) ADDED PART #IAA12FJAI2TZ. 5) ADDED "CODE 1F15-12R2" IN NOTE #5. 6) ADDED NOTE #8. 7) WAS 85.4 [3.36] REF.	2017-03-25 SMP/VVS	0130912-ECO
S	1) NOTE #5(b) WAS "ZINC PLATE PER ES 2751."	2020-07-14 AAG	CO-0205806
T	1) ADDED WEATHERHEAD PART #12Z-692-TZ.	2021-07-28 ASB	CO-0219274

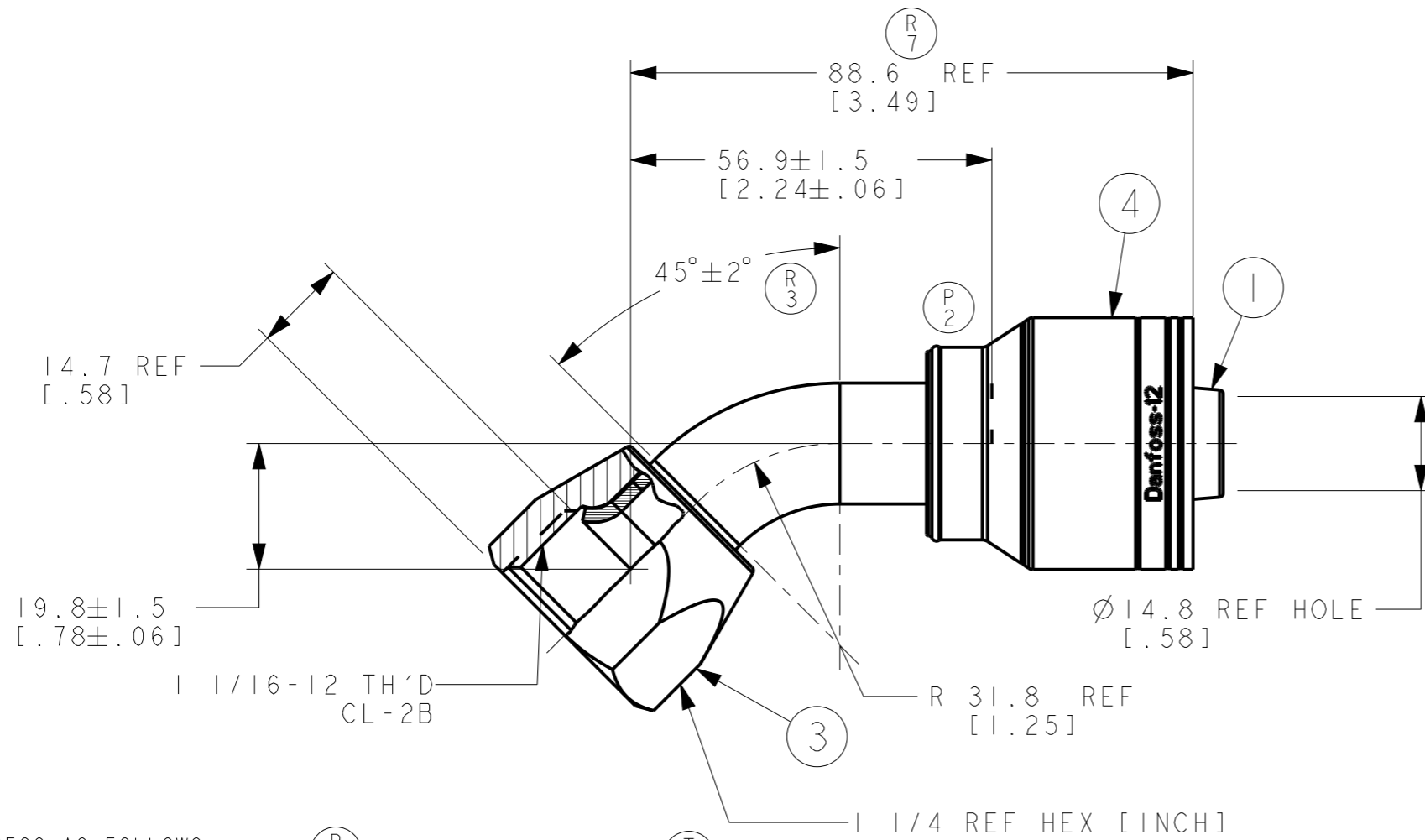

METRIC

8. PROCESS AS FOLLOWS:
 a) RADIUS FLARE PER FF481. (R6)
 b) ZINC NICKEL PLATE PER ES 16P66.
 c) ASSEMBLE NUT AND CRIMP SOCKET PER ACES 2813 CODE 1F15-12R2.
 d) EXPAND NIPPLE PER ES 4377
 e) BEND TO DIMENSIONS SHOWN PER ACES 1964

7. PART IS NOT SHOWN ON DRAWING.

6. PROCESS AS FOLLOWS:
 a) BRAZE PER ES 2814.
 b) ZINC NICKEL PLATE PER ES 16P66.
 c) ASSEMBLE NUT AND FLARE ELBOW PER FF481.
 d) ASSEMBLE SOCKET PER ACES 2813.

5. OPTIONAL LIST OF MATERIAL.
 PROCESS AS FOLLOWS:
 a) RADIUS FLARE PER FF481. (S1)
 b) ZINC PLATE PER ES 2751D8. (R5)
 c) ASSEMBLE NUT AND CRIMP SOCKET PER ACES 2813 CODE 1F15-12R2. (R5)
 d) EXPAND NIPPLE PER ES 4377
 e) BEND TO DIMENSIONS SHOWN PER ACES 1964.

4. (R2)
 3. CAN BE MADE FROM TUBING PER SPECIFICATIONS ON ELBOW DRAWING.
 2. (R2)

1. DIMENSIONS ARE IN MILLIMETERS [INCHES].

(R4) 8	12Z-692-TZ	IAA12FJAI2TZ	IF40331-1212-01	-	503- 210201-12	1F15-12TZ
6	12Z-692-TZ	IAA12FJAI2TZ	IF40014-1212AB	IF40017-12-01AB (7)	503- 210201-12	1A12TZ
(P1) 5	12Z-692	IAA12FJAI2	IF40331-1212-01	-	210201-12S	1F15-12-S
(R1)						
	WEATHERHEAD PART NUMBER	AEROQUIP PART NUMBER	(1) NIPPLE	(2) ELBOW (3)	(3) NUT	(4) SOCKET

LIST OF MATERIALS

ITEM NO.	MATERIAL
1	STEEL
2	STEEL
3	STEEL
4	STEEL

FLUID CONVEYANCE DIVISION
 MAUMEE, OHIO U.S.A.

Danfoss

0120896-ECO CAGE CODE 01276

THIRD ANGLE PROJECTION DIST U

SIZE A3
 SCALE 1/1
 SHEET 1

DRAWN S. DAVKHAR
 CHECKED S. DAVKHAR
 APPROVED M. WELLS
 RELEASE DATE 2016-03-18
 DRAWING INTERPRETATION PER ES 10
 DRAWING TITLE
 FITTING ASSEMBLY
 45°, SAE 37° FEMALE SWIVEL
 1 AND 2 WIRE BRAIDED HOSE

DRAWING NUMBER IAA12FJAI2 REV T

THE REPRODUCTION, DISTRIBUTION, AND UTILIZATION OF THIS DOCUMENT AS WELL AS THE COMMUNICATION OF ITS CONTENTS TO OTHERS WITHOUT EXPLICIT AUTHORIZATION IS PROHIBITED. OFFENDERS WILL BE HELD LIABLE FOR THE PAYMENT OF DAMAGES. ALL RIGHTS RESERVED IN THE EVENT OF THE GRANT OF A PATENT, UTILITY MODEL OR DESIGN. (PER ISO 16016)