

THE REPRODUCTION, DISTRIBUTION AND UTILIZATION OF THIS DOCUMENT AS WELL AS THE COMMUNICATION OF ITS CONTENTS TO OTHERS WITHOUT EXPLICIT AUTHORIZATION IS PROHIBITED. OFFENDERS WILL BE HELD LIABLE FOR THE PAYMENT OF DAMAGES. ALL RIGHTS RESERVED IN THE EVENT OF THE GRANT OF A PATENT, UTILITY MODEL OR DESIGN. (PER ISO 18018)

REVISIONS

REV	DESCRIPTION	DATE	APPROVED
D	REDRAWN - SUPERSEDES 1GA_FRB_SHEET 2 REV. C FOR 1GA4FRB4 (1) WAS 8.2 REF	12-8-95	EN-F16102 DP-24900

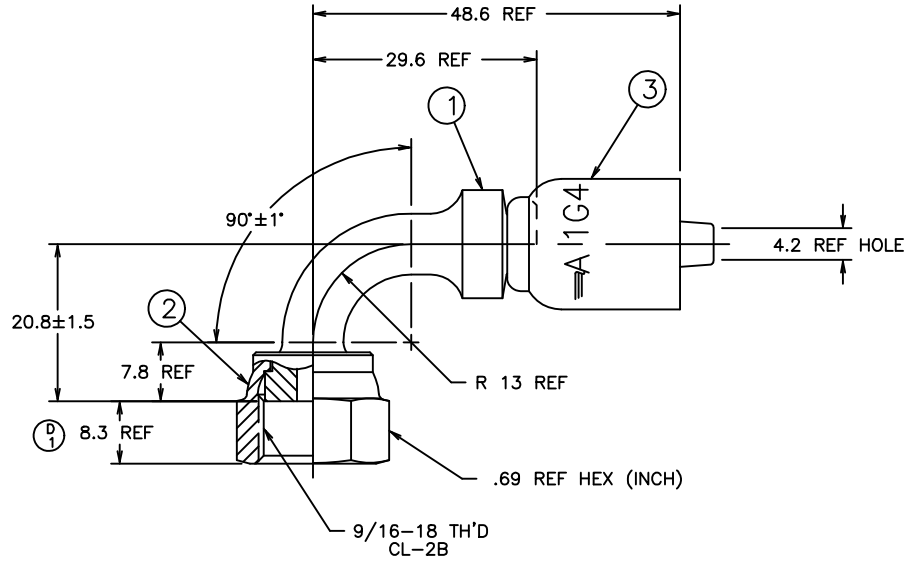

48.6	1.91
29.6	1.17
20.8±1.5	.82±.06
13	.51
8.3	.33
7.8	.31
4.2	.17
MM	INCH

CONVERSION

METRIC

2. 1SA4FRB4 NIPPLE ASSEMBLY MAY BE SUBSTITUTED FOR ITEMS #1 AND #2.

1. PROCESS AS FOLLOWS:
- BEND NIPPLE TO DIMENSIONS SHOWN.
  - ZINC PLATE PER ACES 2751.
  - CRIMP NUT PER ACES 2409P1.
  - ASSEMBLE SOCKET PER ACES 2813.

1GA4FRB4	1F40023-0404AB	FC1473-04S	1G4		
AEROQUIP PART NUMBER	① NIPPLE	② NUT	③ SOCKET		
LIST OF MATERIALS					
ITEM NO.	MATERIAL	DRAWN M MOLINA			
1	STEEL	CHECKED R.D.GARRETT			
2	STEEL	APPROVED R.D.GARRETT			
3	STEEL	RELEASE DATE 12-8-95			
		EN-F16102 DP-24900		SIZE C	DRAWING NUMBER 1GA4FRB4
		THIRD ANGLE PROJECTION		SCALE 2/1	DIST U
				CAGE CODE 01276	SHEET NO

*Danfoss* FLUID CONVEYANCE DIVISION

DRAWING TITLE  
FITTING ASSEMBLY  
90°, ORS FEMALE SWIVEL, OTC

REV D

DWG. NO. 1GA4FRB4 SH. D

CONVERTED DRAWING CADAM to AutoCAD 8/98