

PART NUMBER	TH'D "P1"	TH'D "P2"	TH'D "T"	A REF	B REF	C REF	D REF	E REF	F REF
203104-2-4S	1/8-27	1/8-27	7/16-20	27.4 [1.08]	16.8 [.66]	16.8 [.66]	4.3 [.17]	7.4 [.29]	7.4 [.29]
203104-4-6S	1/4-18	1/4-18	9/16-18	31.2 [1.23]	22.4 [.88]	22.4 [.88]	7.6 [.30]	9.9 [.39]	9.9 [.39]
203104-8-10S	1/2-14	1/2-14	7/8-14	41.7 [1.64]	31.2 [1.23]	31.2 [1.23]	12.2 [.48]	16.5 [.65]	16.5 [.65]
203104-16-16S	1-11 1/2	1-11 1/2	1 5/16-12	55.1 [2.17]	41.1 [1.62]	41.1 [1.62]	21.3 [.84]	26.9 [1.06]	26.9 [1.06]
203104-20-20S	1 1/4-11 1/2	1 1/4-11 1/2	1 5/8-12	59.2 [2.33]	43.2 [1.70]	43.2 [1.70]	27.4 [1.08]	35.6 [1.40]	35.6 [1.40]

Ⓐ Ⓑ

REVISIONS			
REV	DESCRIPTION	DATE	APPROVED
A	REDRAWN, UPDATED TO DANFOSS FORMAT & DIMENSION STYLE. 1) ADDED PART #203104-24-24S.	2010-05-04 SJM/SRH	0005620-ECO
B	REMOVED PART #203104-24-24S	2013-04-25 NMS/AGV	0084460-ECO DP-1299

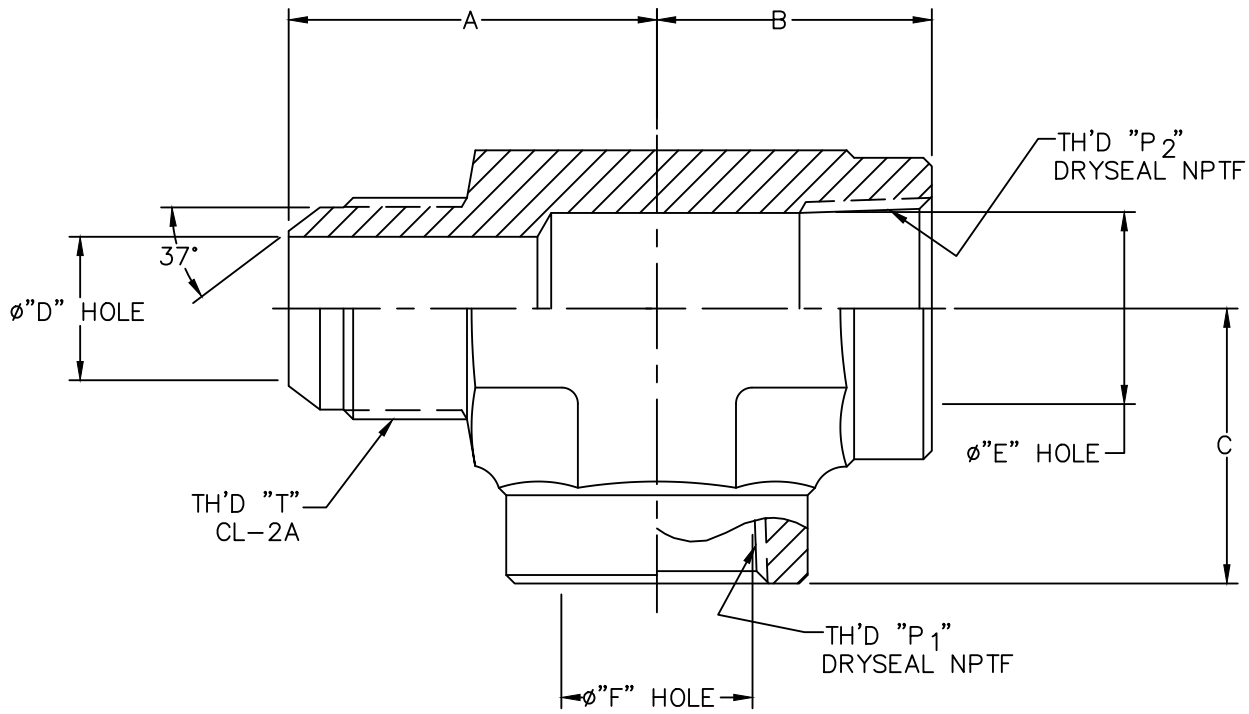

METRIC

2. MATERIAL: STEEL.

1. DIMENSIONS ARE IN MILLIMETERS [INCHES].

DRAWN S. MANE	Danfoss FLUID CONVEYANCE DIVISION		
CHECKED S. HASABE	DRAWING TITLE		
APPROVED J. LUGINBILL	ADAPTER		
RELEASE DATE 2010-05-04	TEE, FEMALE PIPE TO SAE 37° MALE FLARE		
0005620-ECO	WITH FEMALE PIPE BRANCH		
THIRD ANGLE PROJECTION	SIZE A2	DRAWING NUMBER 203104-S	REV B
	SCALE NONE	DIST U	CAGE CODE 01276
		SHEET 2	
THE REPRODUCTION, DISTRIBUTION AND UTILIZATION OF THIS DOCUMENT AS WELL AS THE COMMUNICATION OF ITS CONTENTS TO OTHERS WITHOUT EXPLICIT AUTHORIZATION IS PROHIBITED. OFFENDERS WILL BE HELD LIABLE FOR THE PAYMENT OF DAMAGES. ALL RIGHT RESERVED IN THE EVENT OF THE GRANT OF A PATENT, UTILITY MODEL OR DESIGN. (PER ISO 16016)			

DWG. NO. 203104-S
SH. 2
REV. B