

PART NUMBER	TH'D "P <sub>1</sub> "	TH'D "P <sub>2</sub> "	A REF	B REF	C REF	D REF	E REF	F REF
2252-2-2S	1/8-27	1/8-27	35.1 [1.38]	17.3 [.68]	4.1 [.16]	7.4 [.29]	24.9 [.98]	14.2 [.56]
2252-4-4S	1/4-18	1/4-18	43.7 [1.72]	22.4 [.88]	7.1 [.28]	9.9 [.39]	30.5 [1.20]	19.1 [.75]
2252-6-6S	3/8-18	3/8-18	45.2 [1.78]	25.9 [1.02]	10.2 [.40]	13.5 [.53]	32.5 [1.28]	22.4 [.88]
2252-8-8S	1/2-14	1/2-14	54.4 [2.14]	31.2 [1.23]	12.2 [.48]	16.5 [.65]	35.1 [1.38]	23.9 [.94]
2252-12-12S	3/4-14	3/4-14	66.3 [2.61]	40.4 [1.59]	18.3 [.72]	21.6 [.85]	45.5 [1.79]	35.1 [1.38]

REVISIONS			
REV	DESCRIPTION	DATE	APPROVED
B	REDRAWN & UPDATED IN DANFOSS FORMAT & DIMENSION STYLE. 1) "FW1764-1212S" WAS "221033-12-12S" 2) "66.3 [2.61]" WAS "2.33". 3) "45.5 [1.79]" WAS "1.60".	2009-03-13 AGV/SRH	0023875-ECO DP-1299

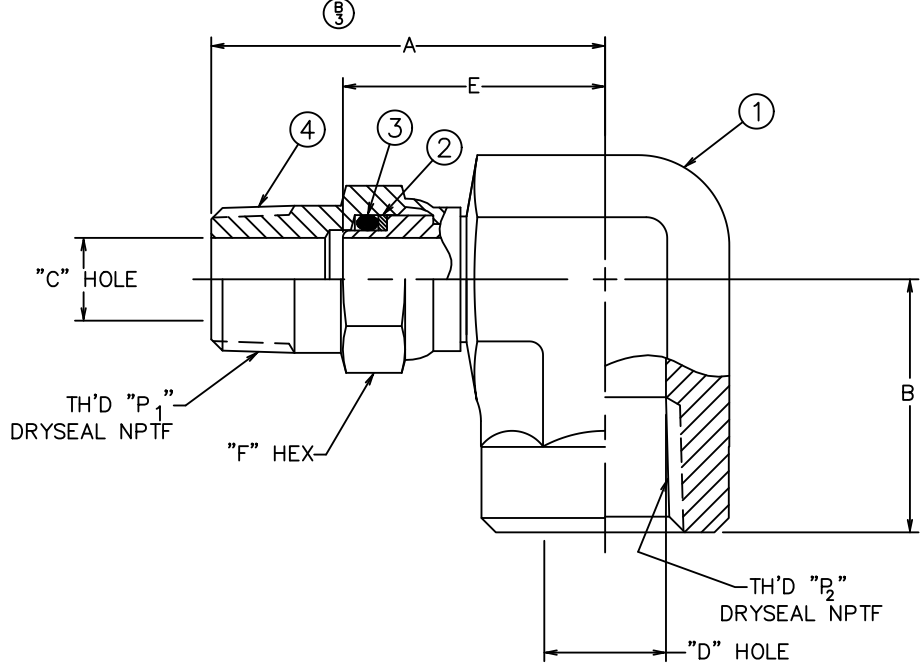

2252-12-12S	FF2723-1212S	22049-212	22550-212	FW1764-1212S $\Delta$ 2
2252-8-8S	FF2723-0808S	22049-113	22550-113	221033-8-8S $\Delta$ 1
2252-6-6S	FF2723-0606S	FF9686-06	22550-112	221033-6-6S $\Delta$ 1
2252-4-4S	FF2723-0404S	FF9686-04	22550-110	221033-4-4S $\Delta$ 1
2252-2-2S	FF2723-0302S	22049-10	22550-10	221033-2-3S $\Delta$ 1
PART NUMBER	$\textcircled{1}$ ADAPTER BODY	$\textcircled{2}$ BACK-UP RING	$\textcircled{3}$ O'RING	$\textcircled{4}$ NUT

LIST OF MATERIALS		DRAWING TITLE	
ITEM NO.	MATERIAL	ADAPTER 90° FEMALE PIPE TO MALE PIPE SWIVEL	
1	STEEL	DRAWING NUMBER <b>2252-S</b>	
2	TEFLON	SCALE	REV B
3	NITRILE (BUNA-N)	NONE	
4	STEEL	DIST U	
		CAGE CODE	SHEET
		01276	1

- 4. ADAPTERS ARE NOT TO BE USED FOR 360° OSCILLATING SERVICE, BUT FEATURE 360° ADJUSTMENT FOR ALIGNMENT PURPOSES.
- 3. 100% INSPECT TO INSURE NUT SWIVELS.
- $\Delta$  ASSEMBLE NUT PER ACES 2813.
- $\Delta$  ASSEMBLE NUT PER ACES 2409.

METRIC

DWG. NO. 2252-S  
ST. 1  
REV. B

THE REPRODUCTION, DISTRIBUTION AND UTILIZATION OF THIS DOCUMENT AS WELL AS THE COMMUNICATION OF ITS CONTENTS TO OTHERS WITHOUT EXPLICIT AUTHORIZATION IS PROHIBITED. OFFENDERS WILL BE HELD LIABLE FOR THE PAYMENT OF DAMAGES. ALL RIGHT RESERVED IN THE EVENT OF THE GRANT OF A PATENT, UTILITY MODEL OR DESIGN. (PER ISO 16016)